



Defence E

Fire Screens & Doors Design Guide

Issue 2 | September 2025

Think partitioning,
think Komfort

Defence E Design Guide

Contents

Overview

Introduction

Specification

Performance

Ironmongery Specification

Junction Drawings

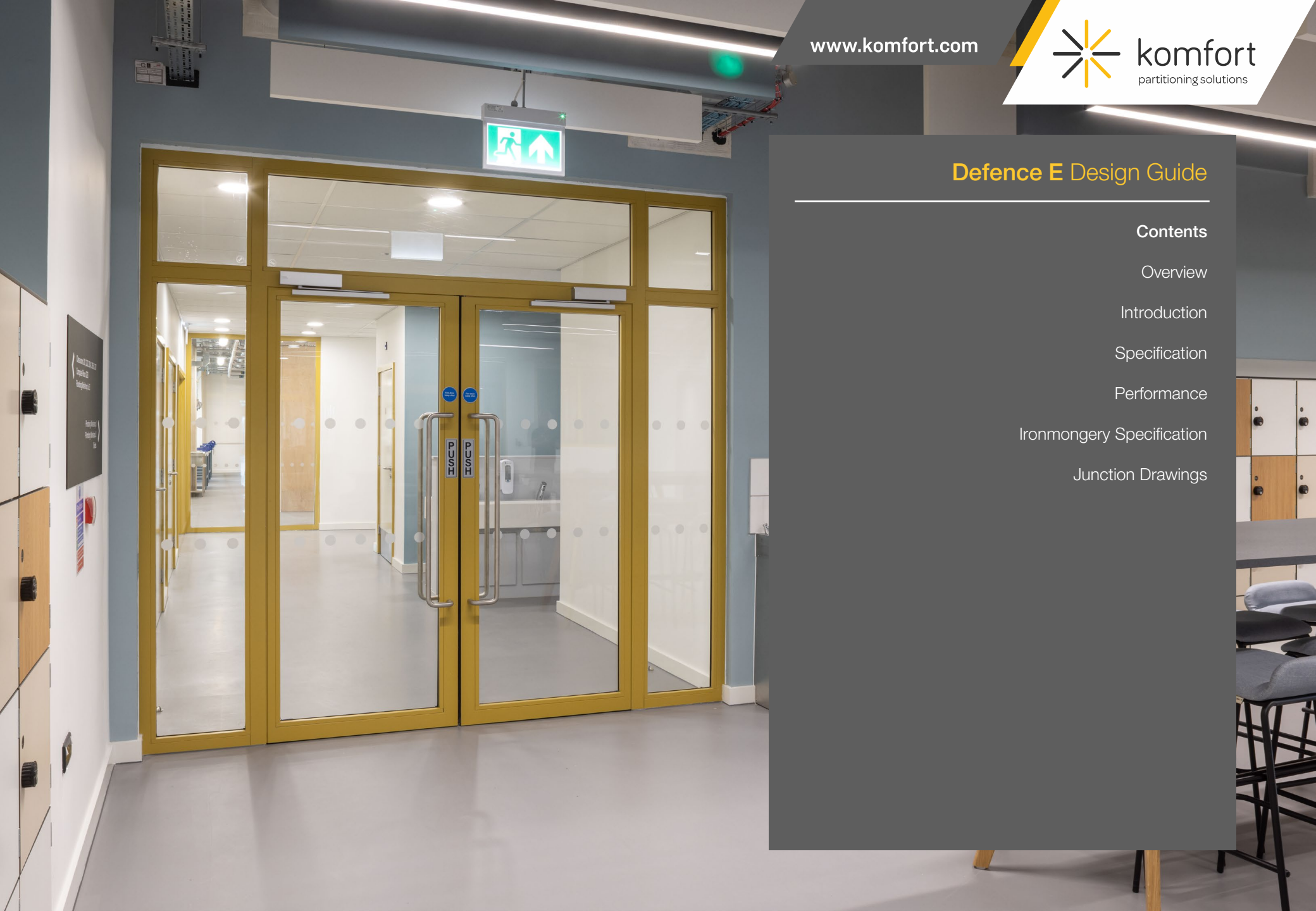

Defence E Overview

Dimensions

Screen Height up to 3.95m*
Module Width up to 2.6m*
Framework Depth 50mm
Framework Weight 4.5kg/lm
Door Leaf Height up to 3.37m*
Door Leaf Width up to 1.46m*

Fire Performance

Up to 60 minutes Integrity Only
Certified in accordance with EN 13501-2 and BS EN 15725:2023

Acoustic Performance

Glazed Screens up to 44dB (R_w)*
Speech Privacy Potential up to 'Good'*

Structural Performance

Up to 3.0kN/m to BS 6180:2011
Subject to Structural Engineers Assessment

Door Options

Single & Double Latched Doors*
Single & Double Unlatched Doors*

Glazing Options

Single Glazed E30-E60 Glass
DGU with Acoustic Laminated Glass

Optional Extras and Finishes

- * Integral Blinds
- ✓ Manifestations
- ✓ Graphics
- * Switch Glass
- * Kross Glaze
- ✓ Polyester Powder Coat Finish

* Dependent on configuration and specification



Defence E Introduction

Fire protection is a critical part of any type of building and interior design, especially in a commercial setting. Fire ratings are used for many different things including doors and non-load bearing elements like glass partitions.

The rating is normally shown as two numbers with a / in-between, where the first number is a number showing the integrity, how long fire can be held back, and the second is insulation, how long the effects of the fire can be held back. Integrity is recognised by using the letter 'E' and insulation is denoted with the symbol 'I'.

Different ratings are used in different applications from offices to shopping centres and more. If you would like to discuss fire ratings and what you may need for your project, please contact our experienced team.

Where are fire-rated partitions required?

When designing buildings, it is crucial to think about fire safety - always design with compartmentation in mind. Compartmentation is the act of subdividing a building into smaller compartments using fire-resistant materials (such as fire-rated partitions) to control and slow the spread of fire, creating more manageable areas of risk.

Key areas for compartmentation are reception areas, corridors, staircases, common areas and escape routes. However, it is important to know that your design will depend on the level of fire safety you require; for example, if you only have 1 escape route, you may need fire rated partitioning which provides 2 hours of fire protection, whereas if you have 2, you may only need 30 mins or an hour.

Where fire-rated partitions are required will also depend on building type, its size and its height which will have different measures and standards. For example, Approved Doc B Volume 1 refers to dwellings, whereas volume 2 refers to commercial buildings and more. Standards for each individual building are laid down by Building Control.

What are fire-rated partitions designed to do?

Essentially fire-rated partitions are designed to keep people safe; they provide protection against fire which enables people to escape the building in the event of a fire and enable enough time for the fire brigade to re-enter the building. Fire-rated partitions and other systems are also installed to avoid the spread of fire to keep the building itself safe. Buildings are very expensive, and the cost of a fire to a business can be very costly.

Fire Screens Support
Tel | +44 (0) 113 395 6565
firescreens@komfort.co.uk

Specifier Support
Tel | +44 (0) 121 332 2550
specifiersupport@komfort.co.uk

Technical Support
Tel | +44 (0) 1403 390 390
technical@komfort.co.uk

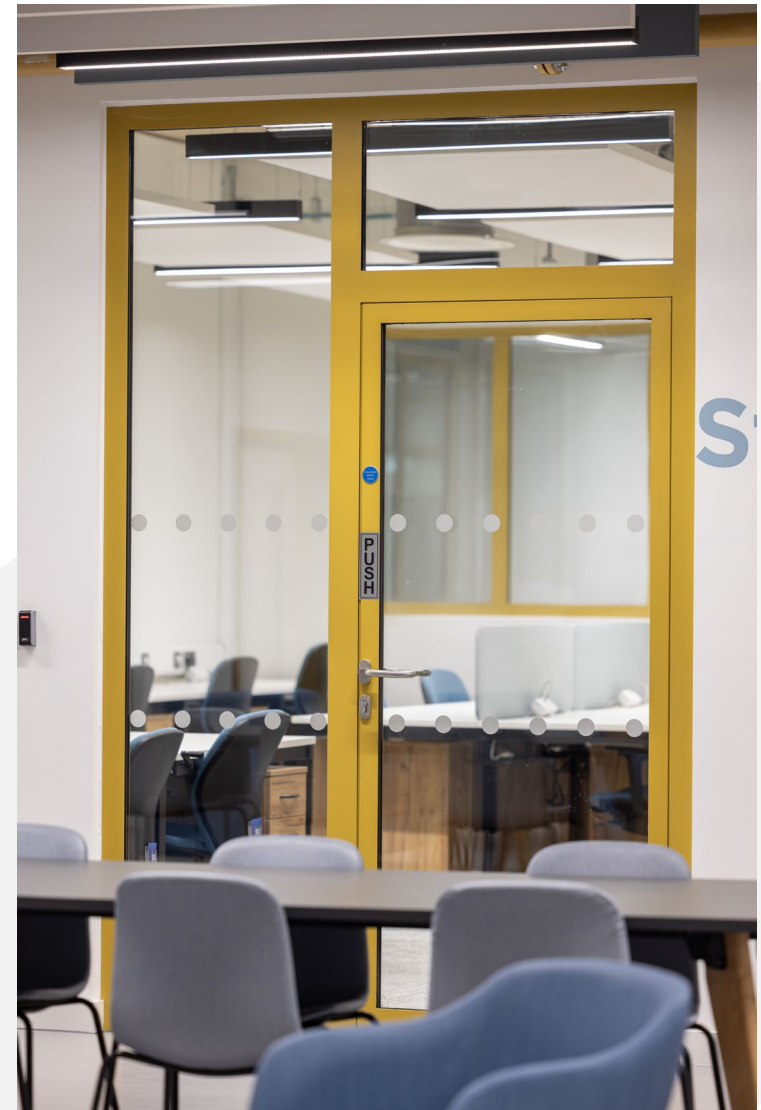

Defence E Specification

Komfort's Defence E Fire Screens offer integrity performance only. This system works to prevent the passage of fire, including flames and flammable gases, but not heat. Constructed using a 50mm deep steel framework and offering fire ratings from 30 minutes to 60 minutes, with acoustic performance up to 44dB (R_{w}), to meet a range of project specifications to fit seamlessly into your design whilst providing protection against fire.

The system can also be complemented with both latched or unlatched, single or double doors with a range of ironmongery options.

This product is available on NBS Source.

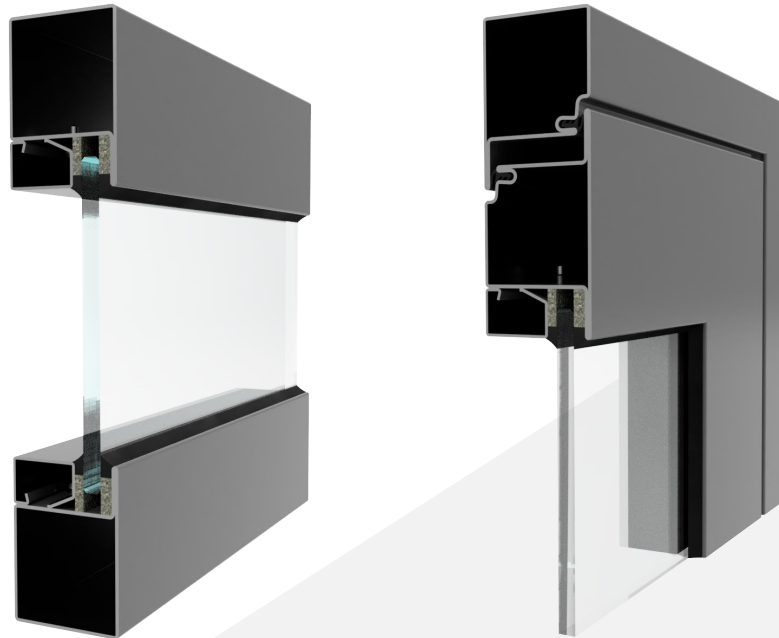

Defence E Specification

The Defence E technical parameters shown below are for guidance. For information regarding system application, specification or any technical questions, contact our specialist Fire Screen department.

Technical Limitations of Defence E Fire Screens		
	Defence E30	Defence E60
Max. Screen Height	3950mm	3350mm
Framework Depth	50mm	50mm
Framework Weight	4.5kg/lm	4.5kg/lm
Glass to Glass Butt Joint	No	No
Max. Size Single Latched Doors†	1460 x 2875mm	1460 x 2875mm
Max Size Double Latched Doors†	2830 x 3370mm	2860 x 2930mm
Max. Size Single Unlatched Doors†	1370 x 2540mm	1370 x 2540mm
Max. Size Double Unlatched Doors†	2390 x 2540mm	2930 x 2540mm

† Dimensions shown refer to clearance between the outer frame. Subject to a maximum leaf area.

Building Regulations Document K

Glazed screens and doors must be provided with the following:

- ✓ Manifestation that will contrast visually with the background seen through the glass, both from inside and outside in all lighting conditions.
- ✓ Manifestation at two levels as shown below, between 850mm-1000mm and 1400mm-1600mm.
- ✓ Manifestation in the form of a logo or sign a minimum of 150mm high or a decorative feature, continuous bands a minimum of 50mm high.
- ✓ Where glazed doors are beside or part of a glazed screen they are clearly marked with a high-contrast strip at the top and on both sides.

Ceiling

1600mm
1400mm

1000mm
850mm

Floor

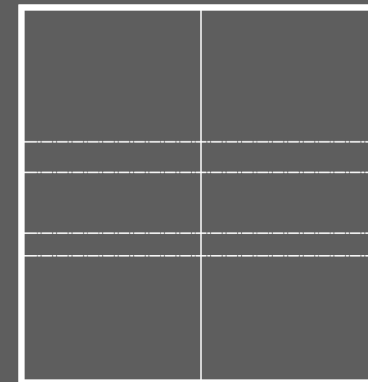

150mm min  komfort

50mm min  ■ ■ ■ ■ or ● ● ● ● or 

Defence E Performance

The Defence E performance data shown below is for guidance, fire rating is certified in accordance with EN 13501-2 and BS EN 15725:2023. For information regarding system application, specification or any technical questions, contact our specialist Fire Screen department.

Fire & Acoustic Performance of Defence E Fire Screens			
Glass Configuration	Fire Rating	dB Rating	Weight
13mm Pyroguard T	E30-E60	37dB (R_w) [†]	29.4kg/m ²
13mm Contraflam Lite	E30	38dB (R_w) [†]	29.5kg/m ²
14mm Contraflam Lite	E60	38dB (R_w) [†]	31.0kg/m ²
19mm Pyroguard T	E30-E60	40dB (R_w) [†]	44.4kg/m ²
13mm Pyroguard T & 8.8mm Aco. Lam. DGU	E30-E60	44dB (R_w) [†]	51.4kg/m ²

It should be noted that in an on-site acoustic test, a doorset can result in a 3dB to 5dB lesser performance than under laboratory conditions. This can be further affected by ambient noise levels on the receiving side of the test sample and by poorly insulated abutments and voids above and below the partition which will result in a 'flanking' path for audible sound.

[†] This glass type has not been laboratory tested by Komfort and the sound insulation rating shown is assessed based on the glass manufacturers data.



Defence E Performance

Examples of Speech Privacy Potential for Defence E Fire Screens are given below with varying degrees of background noise levels for office environments.

Speech Privacy Potential of Defence E Fire Screens				
Glass Type & Sound Level Difference	Privacy of Speech from the Next Room with Background Noise Level			
	25dBA	30dBA	35dBA	40dBA
13mm Pyroguard T 33dB (D_w)*	58 - Poor	63 - Poor	68 - Basic	73 - Basic
13mm Contraflam Lt 34dB (D_w)*	59 - Poor	64 - Poor	69 - Basic	74 - Basic
14mm Contraflam Lt 34dB (D_w)*	59 - Poor	64 - Poor	69 - Basic	74 - Basic
19mm Pyroguard T 36dB (D_w)*	61 - Poor	66 - Basic	71 - Basic	76 - Good
13mm PT & 8.8mm DGU 40dB (D_w)*	65 - Basic	70 - Basic	75 - Good	80 - Good

* The examples of weighted sound level difference (D_w) data shown is assumed as a nominal 4dB less than the weighted sound reduction index (R_w) from laboratory testing, as with an on-site acoustic test a glazed partition can result in a 3dB to 5dB lesser performance than under laboratory conditions. This can be further affected by ambient noise levels on the receiving side of the test sample and by poorly insulated abutments and voids above and below the partition which will result in a 'flanking' path for audible sound.

Speech Privacy Potential Explained

Speech Privacy Potential (SPP) is the value and rating of speech intelligibility between two rooms. The privacy of the partition is determined by the intelligibility of speech outside of the room that is generated within the room. A partition can provide a high degree of speech privacy, even if speech is audible, provided that speech is not intelligible. The poorer the speech intelligibility, the more private the room.

It must be noted that the aim of creating privacy between rooms lies in reducing speech intelligibility to a level at which speech cannot be understood, rather than reducing speech level to inaudibility.

Speech Privacy Potential is calculated from the addition of two factors; the background noise level of the receiving room, expressed in terms of dBA, and the acoustic separation of the partition between the rooms, expressed as the field performance sound insulation of the partition in dB (D_w).

The values and corresponding degrees of privacy ratings are shown in the table below.

$$dB (D_w) + dBA = SPP$$

Rating	SPP	Description of Privacy
High	85 <	Raised voices are barely audible and unintelligible
Good	75-84	Normal speech is barely audible, raised voices are mostly unintelligible
Basic	65-74	Normal speech can be overheard some of the time, raised voices can be heard
Poor	< 65	Normal speech can be heard most of the time

Defence E Ironmongery Specification

The Defence E doors offer a wide variety of quality ironmongery options as standard to provide flexibility in design and better suitability for designer specifications and budgets. Handle options include lever handles in mitre or radius styles, as locking and non-locking. Pull handles are available in various lengths, styles and diameters, with locking options. As well as a selection of sliding cam-action overhead door closers.

Our lock cases have a 30mm backset, available as latches and sashlocks for lever handles or dead locks threaded rod locks to suite with pull handles. Lockable doorsets come with a Euro cylinder with a key and thumbturn.

The Defence ironmongery range also include wireless electronic access control options, either as lever handle sets or as a cylinder for use with the pull handles or lever handles offering or with the use of electronic strikes and maglocks.



Defence E Ironmongery Specification

Defence Doors Lever Handle Options

Oval Back Mitre Sprung Lever
Non-Locking



Weight: 1.0kg

Mounted on 30mm Backset Latch - Available in Satin Stainless Steel

Oval Back Radius Sprung Lever
Non-Locking



Weight: 1.0kg

Oval Back Mitre Sprung Lever
Locking



Weight: 1.4kg

Mounted on 30mm Backset Sashlock - Available in Satin Stainless Steel

Oval Back Radius Sprung Lever
Locking



Weight: 1.4kg

Defence Doors Lever Handles

The lever handle range includes two different lever styles; mitred and radiused. Both handles are sprung and are available as locking or non-locking, with a separate oval rose for the cylinder.

All handle options shown are fixed through the door profile.

Dimensions

- Oval Back Sprung Lever – 74mm x 33mm x 14.5mm
- Oval Rose – 74mm x 33mm x 9.5mm
- Mitre Lever – 130mm x 60mm x 19mm Dia.
- Radius Lever – 140mm x 60mm x 19mm Dia.

Lock Options

- Non-Locking – 30mm Backset Latch
- Locking – 30mm Backset Sashlock

Finish Options

- ✓ Satin Stainless Steel

Defence E Ironmongery Specification

Defence Doors Pull Handle Options

600mm or 1200mm Handle
2 Point Fixing

720mm or 1240mm Handle
2-3 Point Fixing

720mm or 1240mm Handle
2 Point Fixing

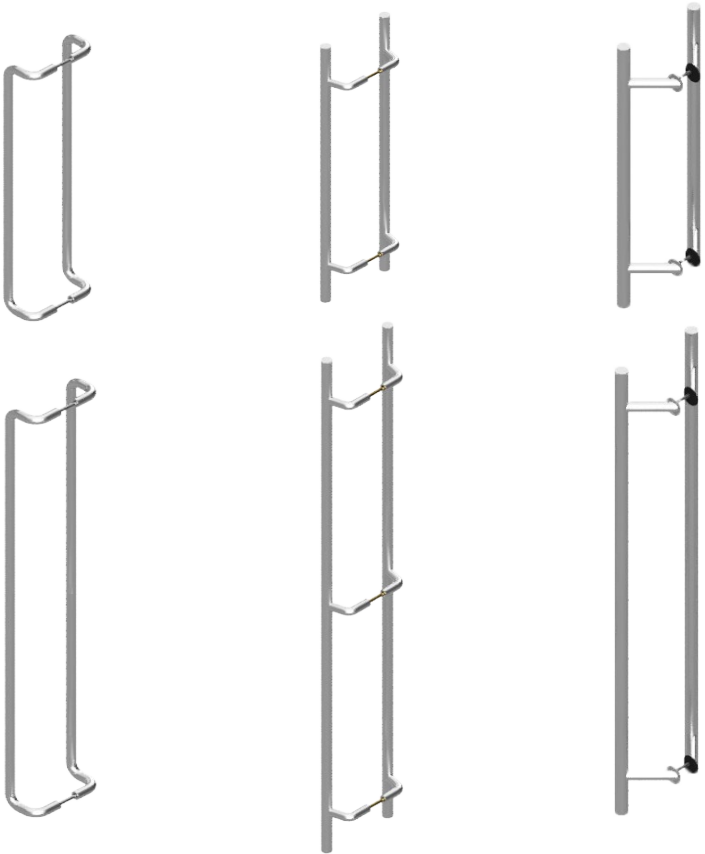

Weight: 0.9-1.8kg

Weight: 2.3-3.7kg

Weight: 2.8-3.7kg

Fixings at 600 or 1200mm

Fixings at 520mm

Fixings at 500 or 1000mm

Defence Doors Pull Handles

The pull handle range includes three styles; the cranked D, the cranked bars and the 45-degree angled bars on circular mounting plates. Each style available in two different lengths, fixed through the steel door profile. All options are available as locking or non-locking. Lockable doors feature the Euro cylinder with thumb turn in an oval rose with 30mm dead lock or 16mm travel thread rods for double doorsets.

Dimensions

620mm x 20mm Dia. Handle – 2 Pt Fixing at 600mm Centres
1200mm x 20mm Dia. Handle – 2 Pt Fixing at 1180mm Centres
720mm x 25mm Dia. Handle – 2 Point Fixing at 520mm Centres
1240mm x 25mm Dia. Handle – 3 Point Fixing at 520mm Centres
700mm x 32mm Dia. Handle – 2 Point Fixing at 500mm Centres
1200mm x 32mm Dia. Handle – 2 Point Fixing at 1000mm Centres

Lock Options

Non-Locking
Locking – 30mm Backset Dead Lock
Locking – 30mm Backset 16mm Travel Thread Rods

Finish Options

- ✓ Satin Stainless Steel
- ✓ Powder Coated to any RAL or BS Colour

Defence E Ironmongery Specification

Defence Doors Overhead Closer Options

Dormakaba TS93 EN 2-5
Sliding Arm Cam-Action Door Closer



Weight: 4.5kg

Arm and Cover Kits are Available in Stainless Steel or PPC to any RAL or BS Colour Code

Defence Doors Overhead Closers

The overhead door closer available for Defence E doors is the compact face mounted sliding arm cam-action TS93 EN 2-5, available in satin stainless steel or powder coated.

Hold Open Function

- ✓ Dormakaba TS93 EN 2-5 Sliding Arm Cam-Action Closer

Finish Options

- ✓ Satin Stainless Steel
- ✓ Powder Coated to any RAL or BS Colour*

* Arm and cover kits for TS93 only

Defence E Ironmongery Specification

Defence Doors Electronic Access Options

Dormakaba C-Lever Pro
Wireless Access Control Handle

Salto XS4 One
Wireless Access Control Handle



Weight: 2.3kg

Weight: 2.3kg

Mounted on 30mm Backset Latch - Available in Satin Stainless Steel

Assa Abloy Eff Eff 118F Profix 2
Electronic Strike

ML600 Fail-Safe Maglock
Monitored with Door Status Mini Magnet



Available for Left and Right Handed Doors
Operating Voltage 12~24V AC/DC

Holding Force up to 280kg
Operating Voltage 12~24Vdc

Defence Doors Electronic Access

Electronic Access options include the Dormakaba C-Lever Pro or Salto XS4 One, both a wireless access control handles, available with a choice of mitre or radius levers. The C-Lever Pro can also be fitted with the S-module to make this hard wired with a cable loop for connection into the existing building system for the centralised control of all doors in case of fire or emergency.*

The Assa Abloy Eff Eff 118F electronic strike for fire resistant doors **must** fail secure. If the door is located on an escape route, then the access control strike must be used in conjunction with an anti-panic function lock, allowing mechanical override to permit egress at all times.

The surface mounted Fail-Safe maglock **may be fitted to either side of the door, depending on security requirements..** This also includes a door status indicator on an independent contact that works separately from the magnet to show door status not lock status with red and green LED's.

Finish Options

- ✓ Satin Stainless Steel

* Programming is not carried out by Komfort



DEFENCE E30

COMPONENT KEY:

1	50 x 70mm Frame L
2	Glazing bead stud
3	25 x 20mm Glazing bead
4	Ceramic glazing tape
5	13mm E30 fire glass

NOTES:
ALL DIMENSIONS ARE NOMINAL & IN mm

JUNCTION CATEGORY:

-  Single Glazed
-  Vertical Screen
-  30 min Integrity
0 min Insulation

DRAWING NO: KDE30-VS-01 DATE: 31/08/22

SCALE: 1:2 ISSUE NO: 01

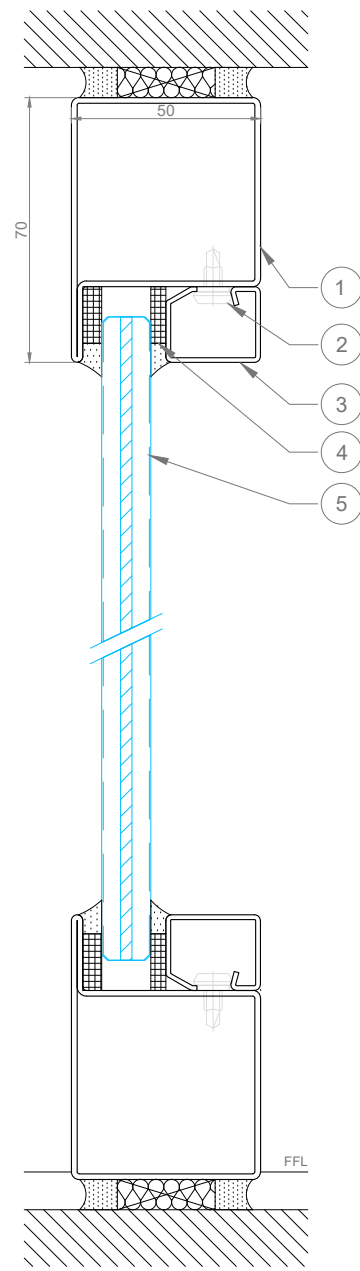
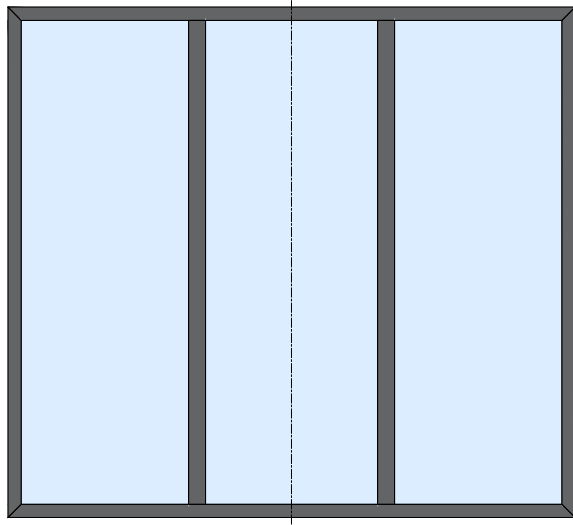

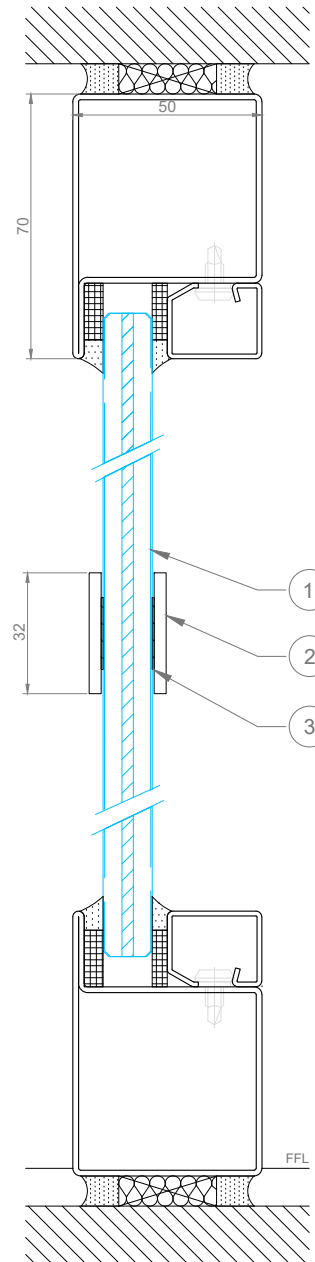
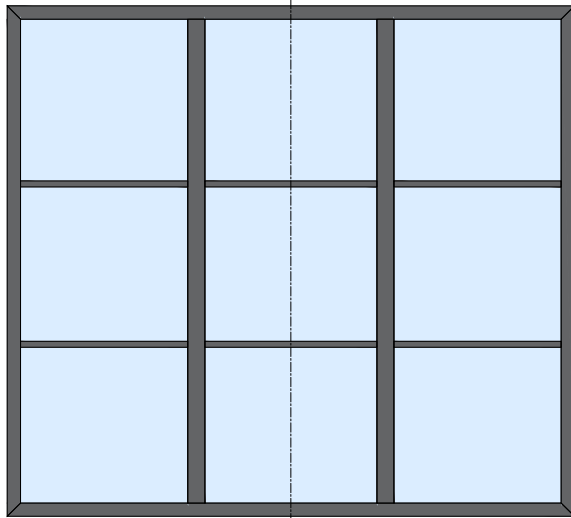

DEFENCE E30



COMPONENT KEY:

1	13mm E30 fire glass
2	109 Glazing bar
3	3M Tape

NOTES:

ALL DIMENSIONS ARE NOMINAL & IN mm

JUNCTION CATEGORY:

-  Single Glazed
-  Vertical Screen
Cross Glaze
-  30 min Integrity
0 min Insulation

DRAWING NO:
KDE30-VS-02

DATE:
20/07/21

SCALE:
1:2

ISSUE NO:
01



DEFENCE E30

COMPONENT KEY:

1	50 x 70mm Frame L
2	Glazing bead stud
3	25 x 20mm Glazing bead
4	Ceramic glazing tape
5	13mm E30 fire glass
6	50 x 90mm Frame T

NOTES:
ALL DIMENSIONS ARE NOMINAL & IN mm

JUNCTION CATEGORY:

-  Single Glazed
-  Horizontal Screen
-  30 min Integrity
0 min Insulation

DRAWING NO: KDE30-HS-01 DATE: 20/07/21

SCALE: 1:2 ISSUE NO: 01

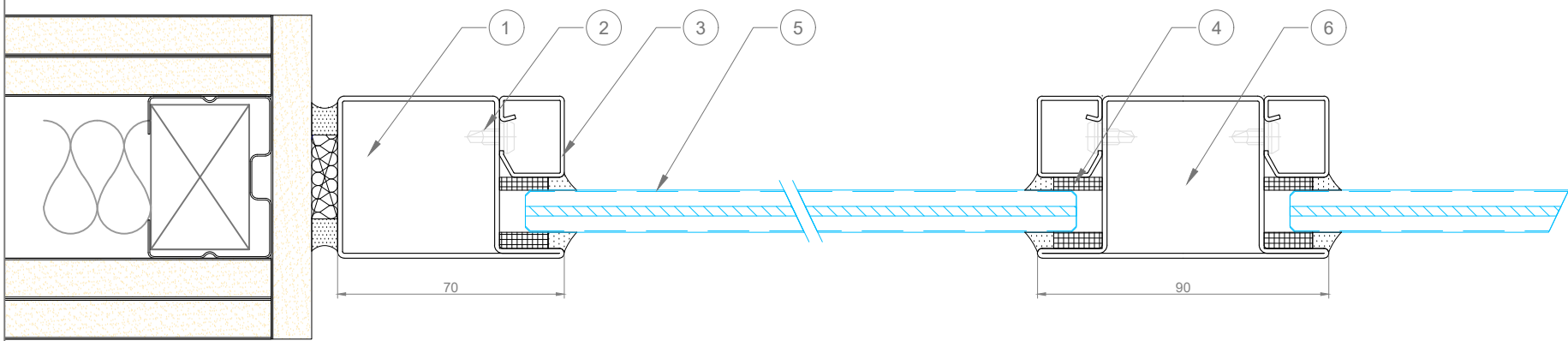
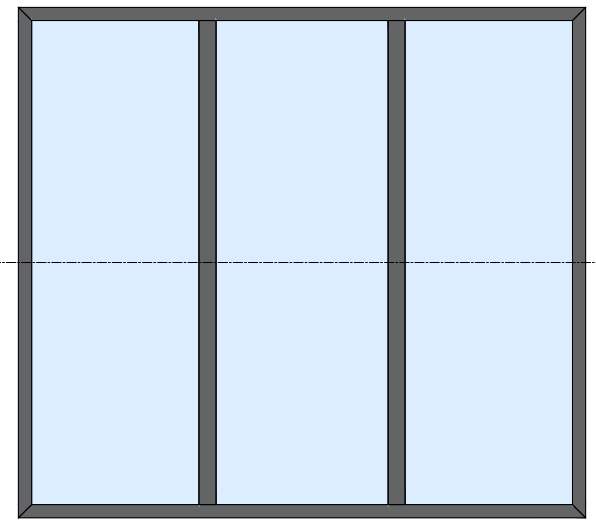



DEFENCE E30

COMPONENT KEY:

1	50 x 70mm Door L
2	Door rebate gasket
3	50 x 90mm Door Z
4	Glazing bead stud
5	25 x 20mm Glazing bead
6	Ceramic glazing tape
7	13mm E30 fire glass
8	50 x 90mm Door H
9	Automatic drop smoke seal

NOTES:
ALL DIMENSIONS ARE NOMINAL & IN mm

JUNCTION CATEGORY:

-  Single Glazed
-  Vertical Door
-  30 min Integrity
0 min Insulation

DRAWING NO: KDE30-VD-01 DATE: 20/07/21

SCALE: 1:2 ISSUE NO: 01

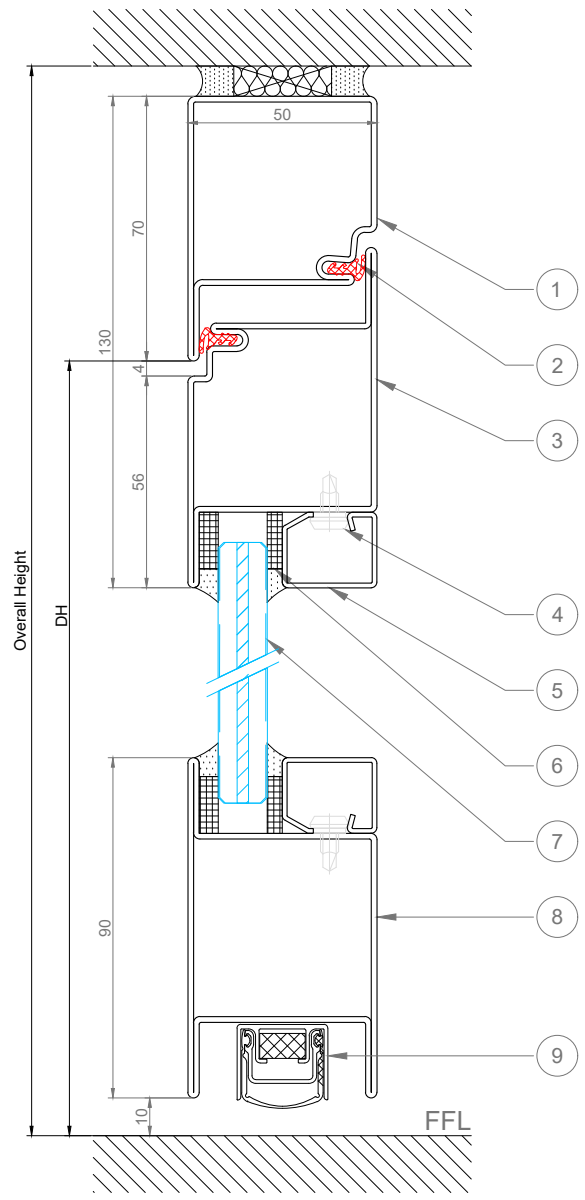
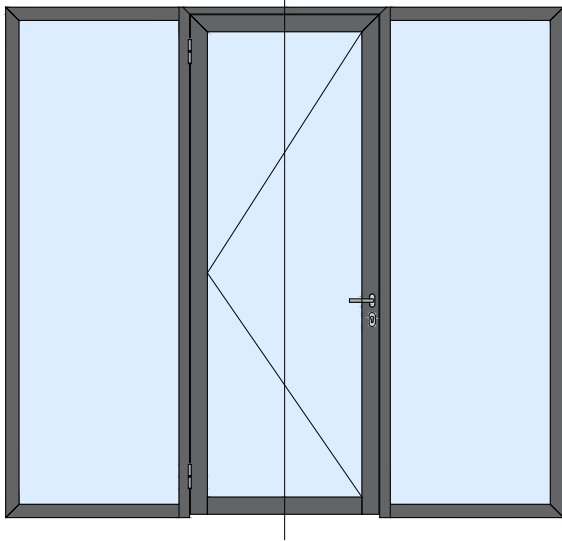

Door Height Parameters		
	Latched doors	Unlatched doors
Max Door Height	3393mm	2540mm
Max Overall Height	3478mm	2625mm

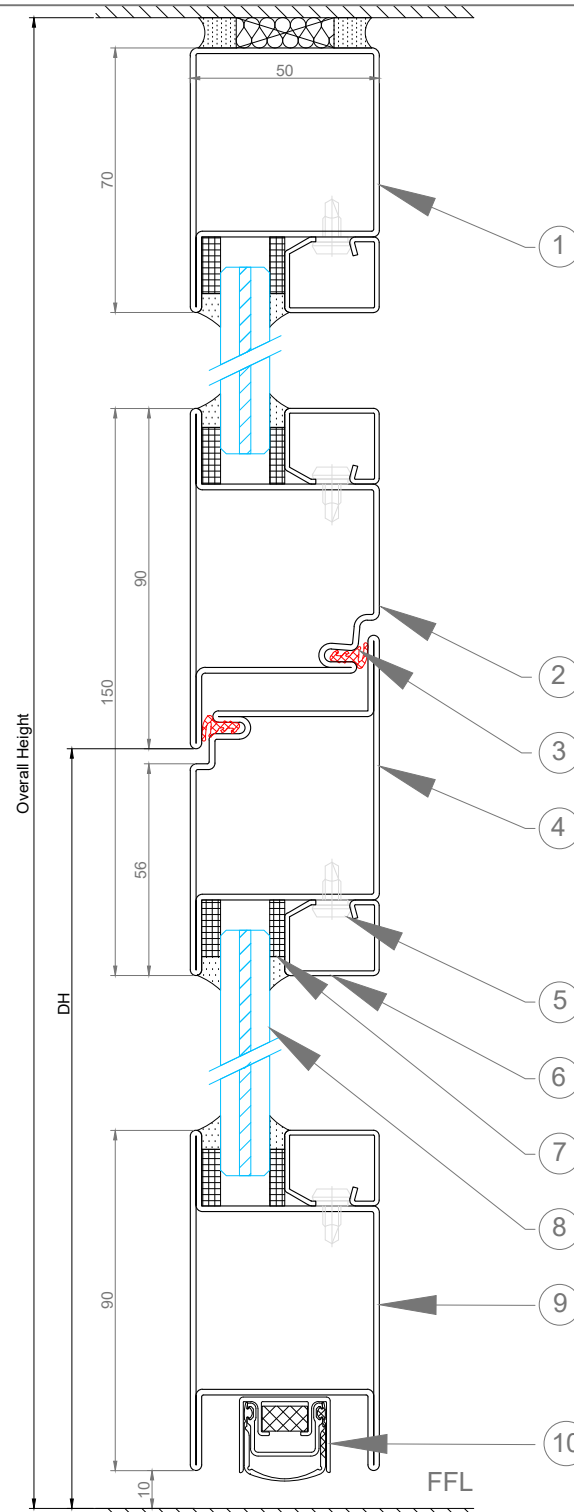
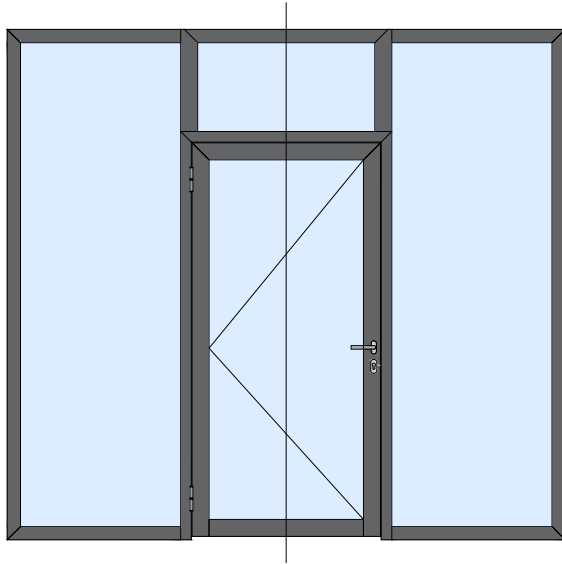

Door Height Parameters		
	Latched	Unlatched
Overpanel Height	970mm	613mm
Door Height	3393mm	2540mm
Overall Height	3950mm	3000mm

DEFENCE E30



COMPONENT KEY:

1	50 x 70mm Frame L
2	50 x 90mm Door T
3	Door rebate gasket
4	50 x 90mm Door Z
5	Glazing bead stud
6	25 x 20mm Glazing bead
7	Ceramic glazing tape
8	13mm E30 fire glass
9	50 x 90mm Door H
10	Automatic drop smoke seal

NOTES:

ALL DIMENSIONS ARE NOMINAL & IN mm

JUNCTION CATEGORY:

-  Single Glazed
-  Vertical Door with overpanel
-  30 min Integrity
0 min Insulation

DRAWING NO: KDE30-VD-02 DATE: 20/07/21

SCALE: 1:2 ISSUE NO: 01

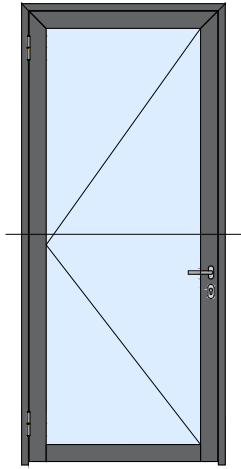

Door Width Parameters		
	Min	Max
DW	500mm	1610mm
ECO = DW - 120mm		



www.komfort.com

DEFENCE E30

COMPONENT KEY:

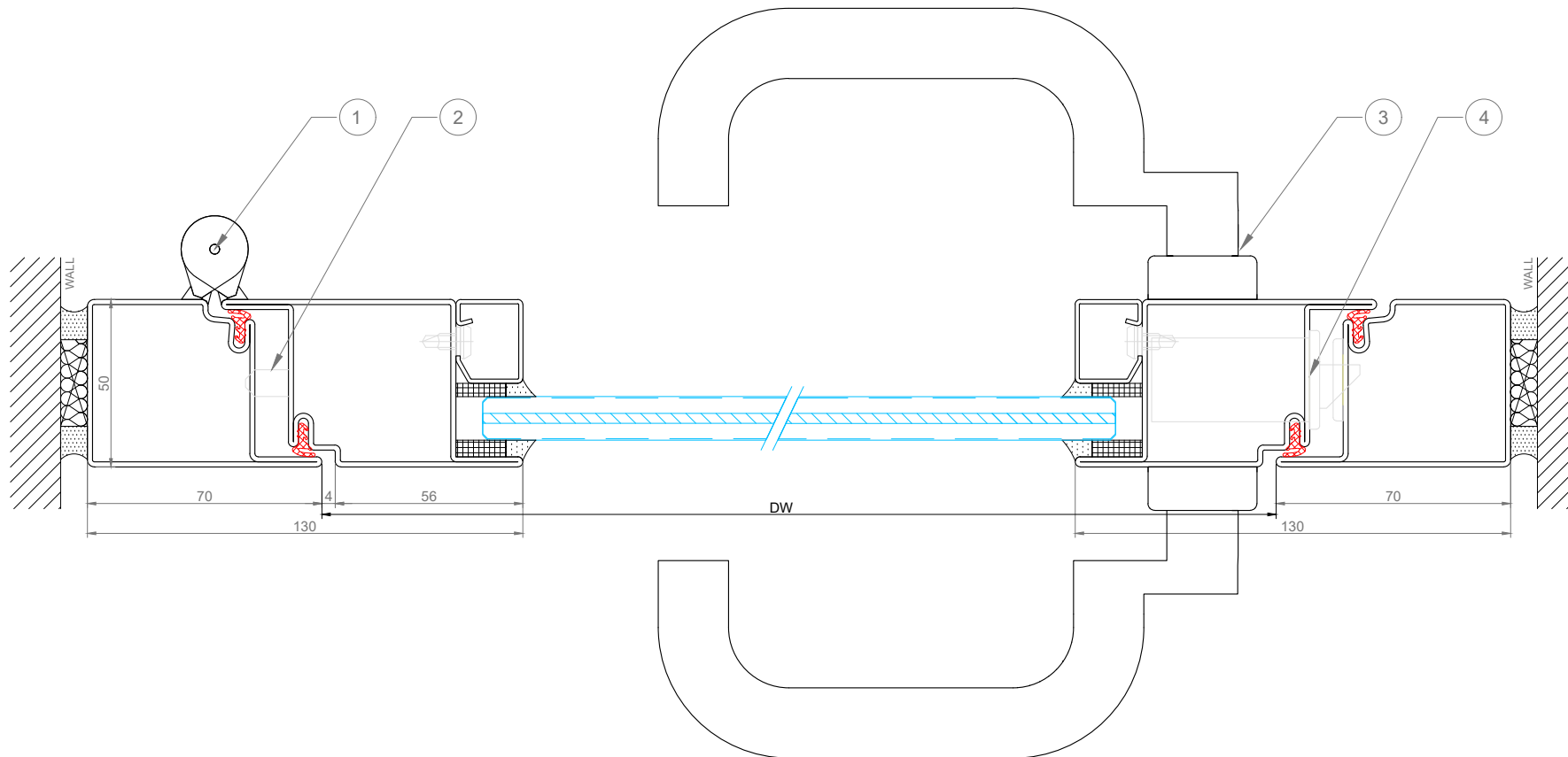

1	Weld-on barrel hinge
2	Hinge locking pin
3	SSS lever handle
4	Latch



NOTES:

ALL DIMENSIONS ARE NOMINAL & IN mm

JUNCTION CATEGORY:

-  Single Glazed
-  Horizontal Single Door Latched & rebated
-  30 min Integrity 0 min Insulation

DRAWING NO:
KDE30-HD-01

DATE:
20/07/21

SCALE:
1:2

ISSUE NO:
01

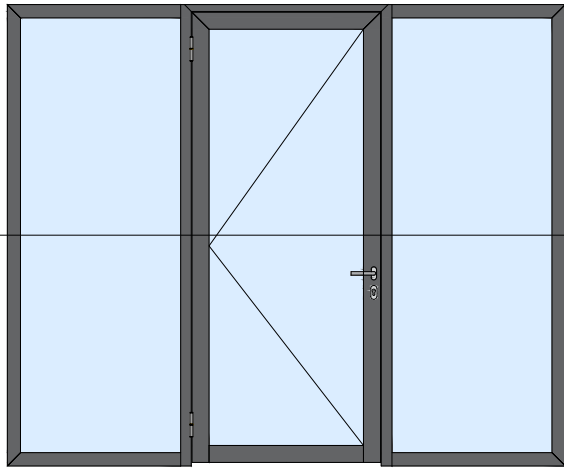

Door Width Parameters		
	Min	Max
DW	500mm	1610mm
ECO = DW - 120mm		



www.komfort.com

DEFENCE E30

COMPONENT KEY:

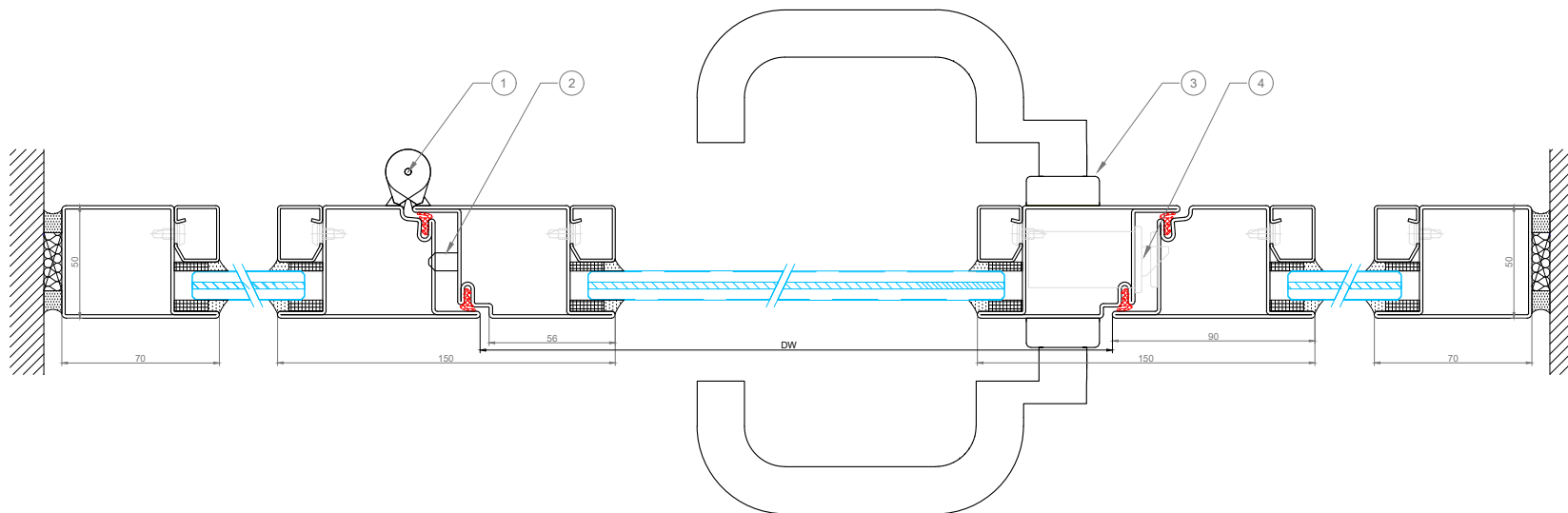

1	Weld-on barrel hinge
2	Hinge locking pin
3	SSS lever handle
4	Latch



NOTES:

ALL DIMENSIONS ARE NOMINAL & IN mm

JUNCTION CATEGORY:

-  Single Glazed
-  Horizontal Single Door Latched & rebated
-  30 min Integrity
0 min Insulation

DRAWING NO: KDE30-HD-02 DATE: 20/07/21

SCALE: 1:2 ISSUE NO: 01

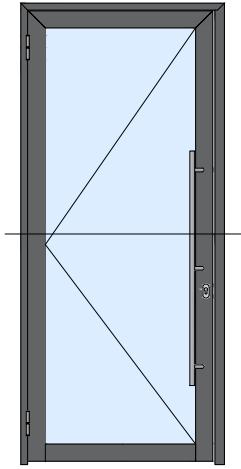

Door Width Parameters		
	Min	Max
DW	532mm	1200mm
ECO = DW - 110mm		



www.komfort.com

DEFENCE E30

COMPONENT KEY:

1	Weld-on barrel hinge
2	Hinge locking pin
3	SSS pull handle
4	Non-rebated meeting style gasket

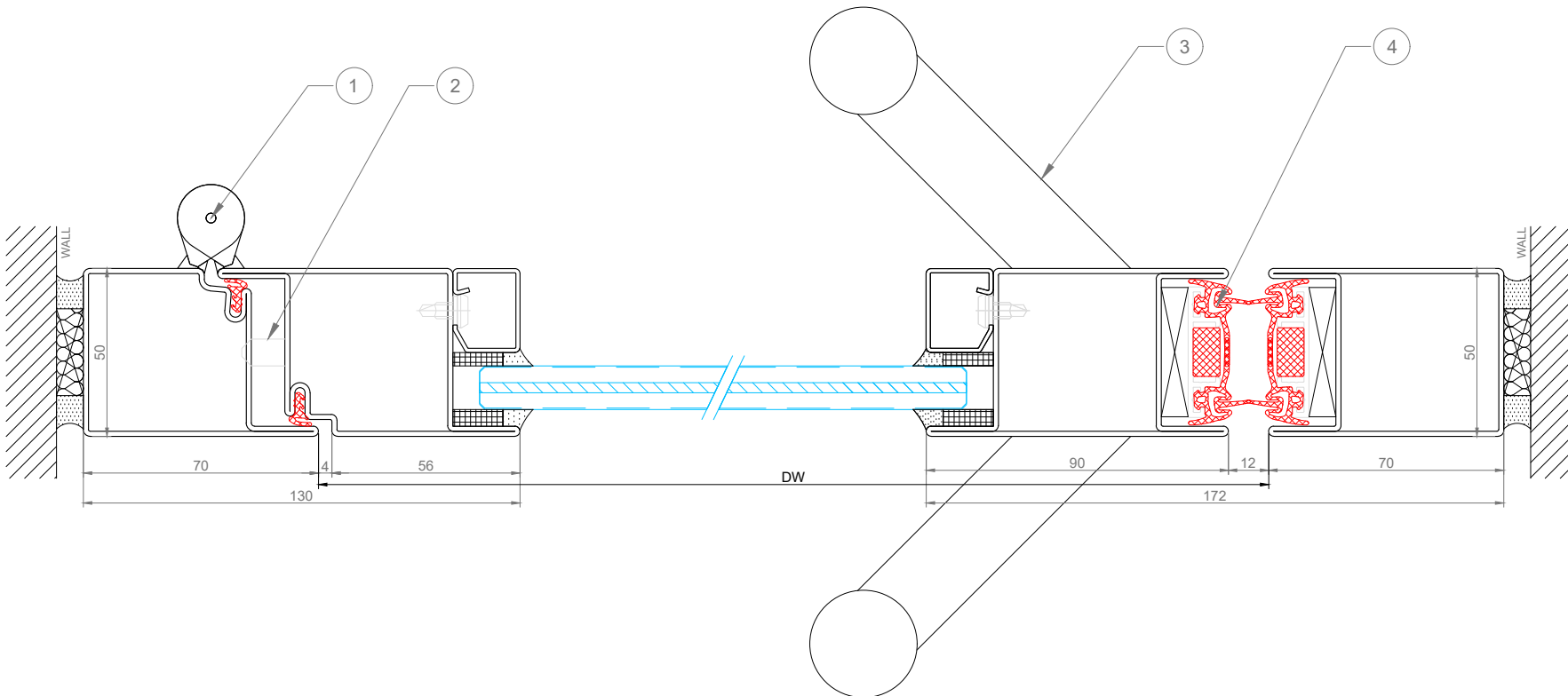

NOTES:

ALL DIMENSIONS ARE NOMINAL & IN mm

JUNCTION CATEGORY:

-  Single Glazed
-  Horizontal Single Door Unlatched
-  30 min Integrity
0 min Insulation

DRAWING NO: KDE30-HD-03 DATE: 20/07/21

SCALE: 1:2 ISSUE NO: 01

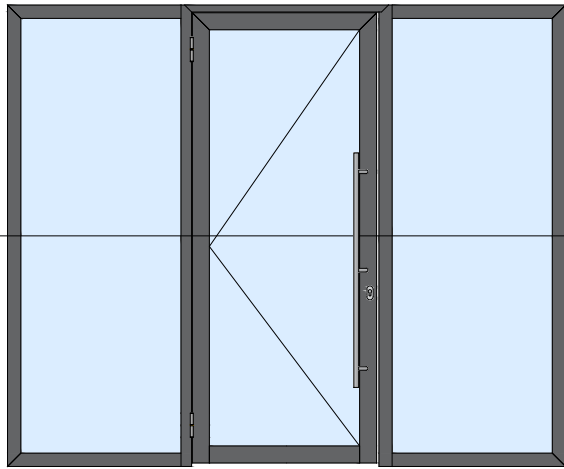

Door Width Parameters		
	Min	Max
DW	532mm	1200mm
ECO = DW - 110mm		



www.komfort.com

DEFENCE E30

COMPONENT KEY:

1	Weld-on barrel hinge
2	Hinge locking pin
3	SSS pull handle
4	Non-rebated meeting style gasket

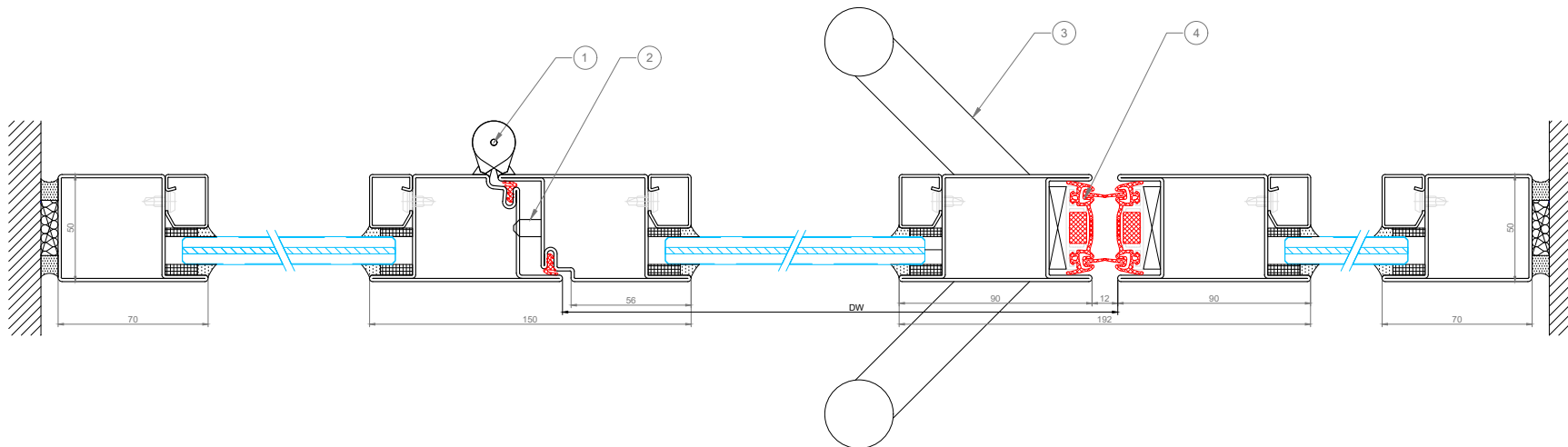

NOTES:

ALL DIMENSIONS ARE NOMINAL & IN mm

JUNCTION CATEGORY:

-  Single Glazed
-  Horizontal Single Door Unlatched
-  30 min Integrity
0 min Insulation

DRAWING NO: KDE30-HD-04 DATE: 20/07/21

SCALE: 1:2 ISSUE NO: 01

Suitable Supporting Structures (Jambs + Head)

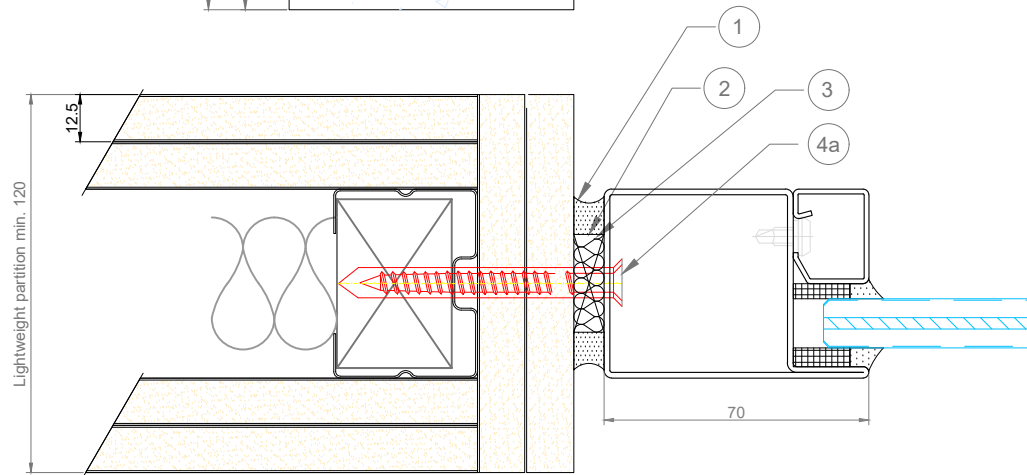
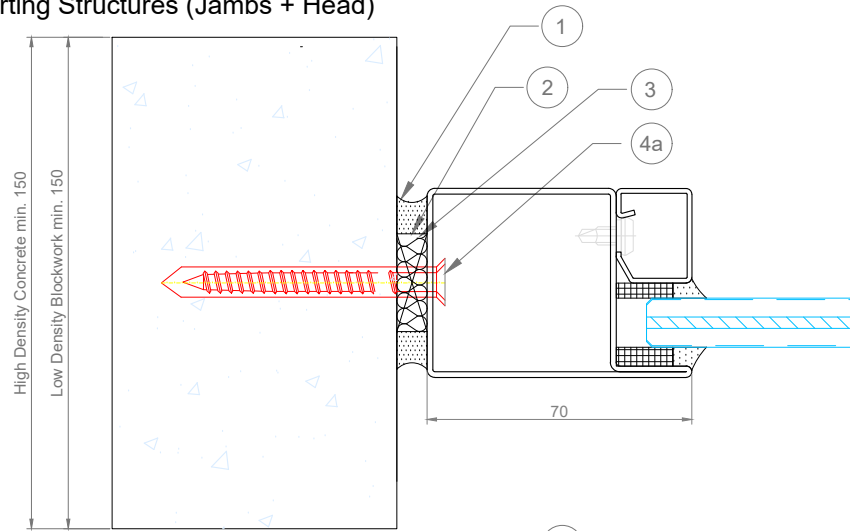

Fixing Locations

x	150mm
y	600mm

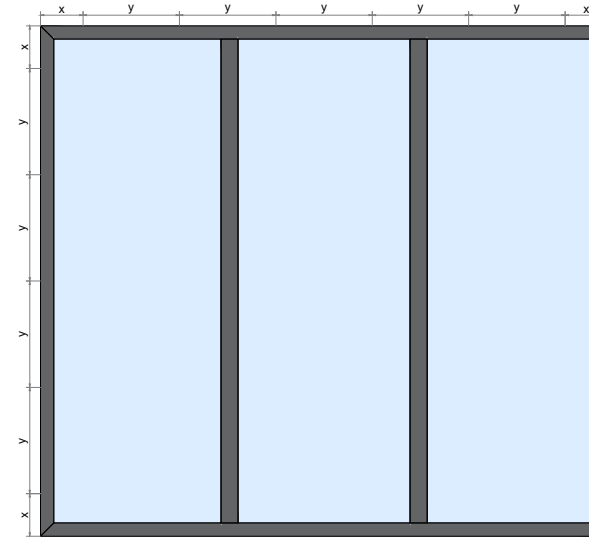

Supporting Construction Parameters

Construction Type	Min thickness	Maximum Height	Butt jointed glazing *
Rigid - High Density	200mm	3950mm	N
Rigid - Low Density	175mm	3110mm	N
Lightweight partition (EN 1364-1)	120mm	3130mm	N



www.komfort.com

DEFENCE E30

COMPONENT KEY:

1	Everbuild 400 FR Sealant
2	Mineral Wool min.80kg/m3
3	Steel packer
4a	8mm Universal (Concrete) Screw
4b	5.5mm Tek Screw

NOTES:

The base construction in all instances must be a rigid supporting structure - typically the structural floor of the building.

Where the element contains a door, the overall height will be limited to the maximum leaf height plus the permitted overpanel height.

ALL DIMENSIONS ARE NOMINAL & IN mm

* Subject to the maximum height of butt-jointed glass product

JUNCTION CATEGORY:



Single Glazed



Fixing & Supporting Constructions



30 min Integrity
0 min Insulation

DRAWING NO:
KDE30-ZZ-01

DATE:
02/09/25

SCALE:
1:2

ISSUE NO:
01

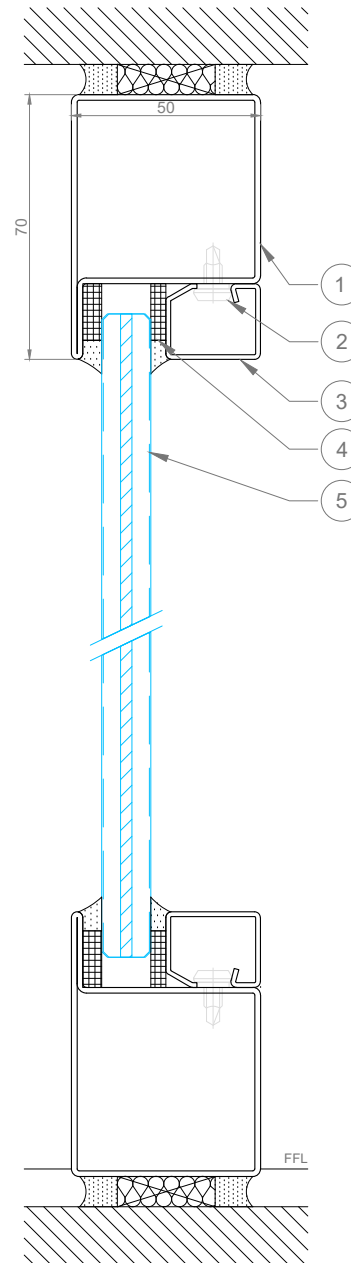
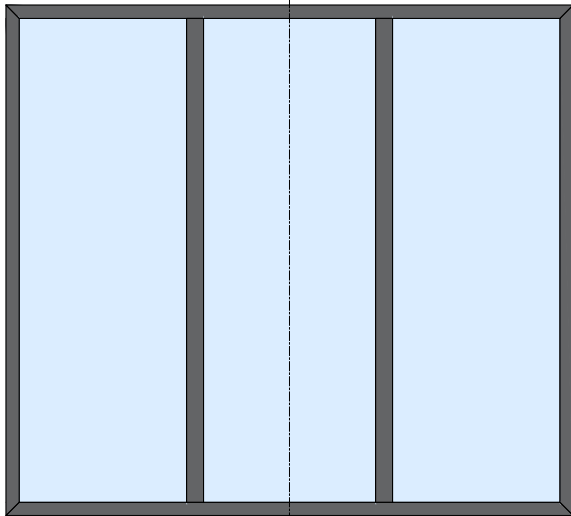

DEFENCE E60



COMPONENT KEY:

1	50 x 70mm Frame L
2	Glazing bead stud
3	25 x 20mm Glazing bead
4	Ceramic glazing tape
5	13mm E60 fire glass

NOTES:

ALL DIMENSIONS ARE NOMINAL & IN mm

JUNCTION CATEGORY:

-  Single Glazed
-  Vertical Screen
-  60 min Integrity
0 min Insulation

DRAWING NO: KDE60-VS-01 DATE: 31/08/22

SCALE: 1:2 ISSUE NO: 01

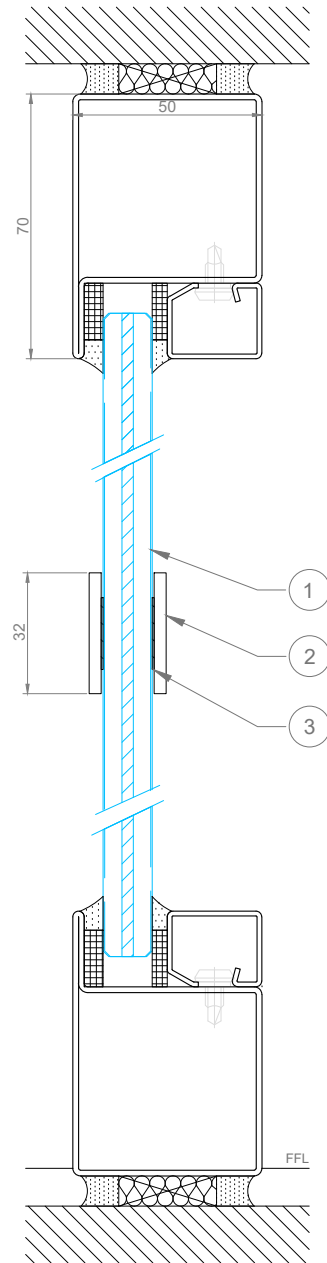
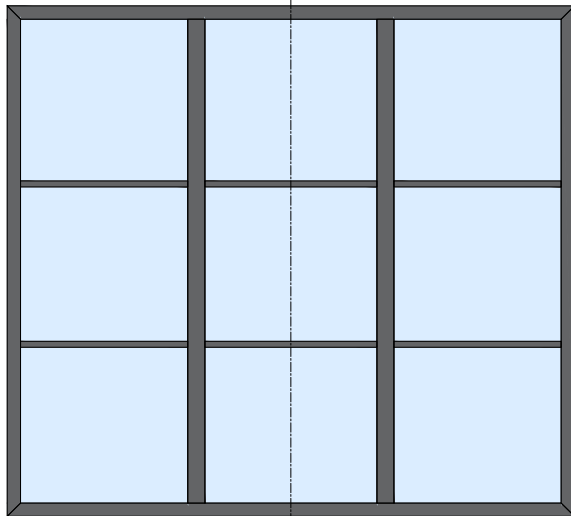

DEFENCE E60



COMPONENT KEY:

1	13mm E60 fire glass
2	109 Glazing bar
3	3M Tape

NOTES:

ALL DIMENSIONS ARE NOMINAL & IN mm

JUNCTION CATEGORY:

-  Single Glazed
-  Vertical Screen
Cross Glaze
-  60 min Integrity
0 min Insulation

DRAWING NO:
KDE60-VS-02

DATE:
20/07/21

SCALE:
1:2

ISSUE NO:
01



DEFENCE E60

COMPONENT KEY:

1	50 x 70mm Frame L
2	Glazing bead stud
3	25 x 20mm Glazing bead
4	Ceramic glazing tape
5	13mm E60 fire glass
6	50 x 90mm Frame T

NOTES:
ALL DIMENSIONS ARE NOMINAL & IN mm

JUNCTION CATEGORY:

-  Single Glazed
-  Horizontal Screen
-  60 min Integrity
0 min Insulation

DRAWING NO: KDE60-HS-01 DATE: 20/07/21

SCALE: 1:2 ISSUE NO: 01

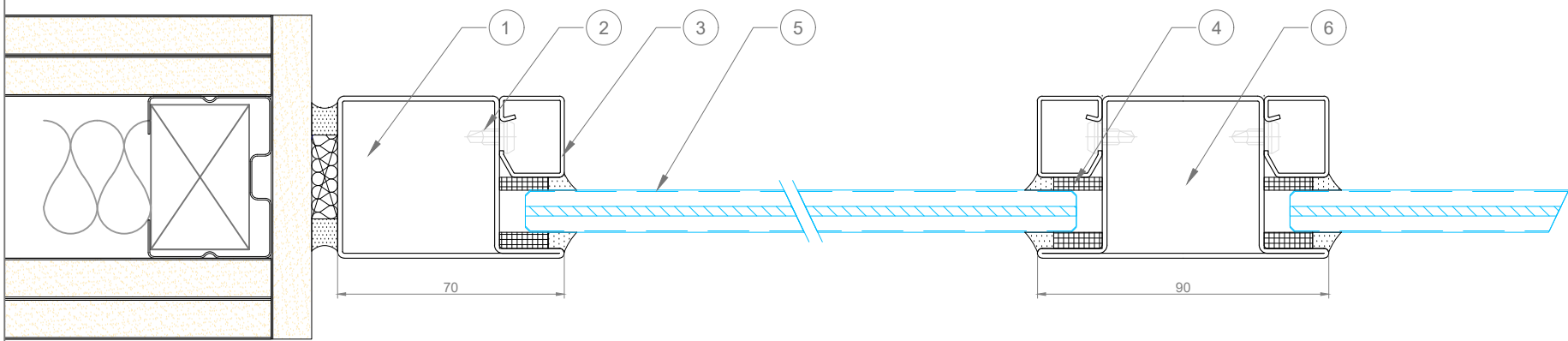
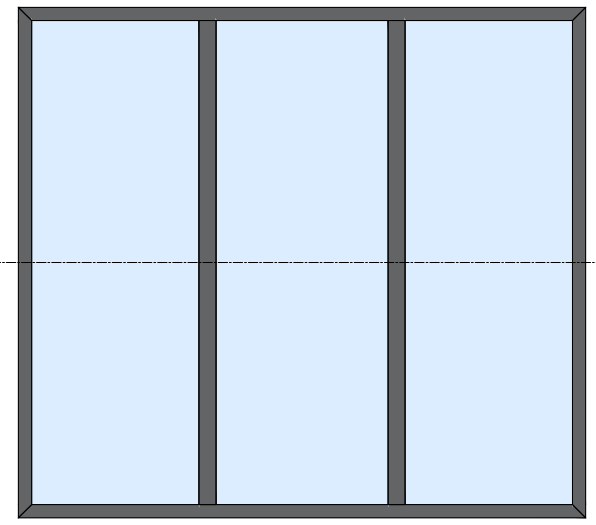

DEFENCE E60



COMPONENT KEY:

1	50 x 70mm Door L
2	Door rebate gasket
3	50 x 90mm Door Z
4	Glazing bead stud
5	25 x 20mm Glazing bead
6	Ceramic glazing tape
7	13mm E60 fire glass
8	50 x 90mm Door H
9	Automatic drop smoke seal

NOTES:

ALL DIMENSIONS ARE NOMINAL & IN mm

JUNCTION CATEGORY:

-  Single Glazed
-  Vertical Door
-  60 min Integrity
0 min Insulation

DRAWING NO: KDE60-VD-01 DATE: 20/07/21

SCALE: 1:2 ISSUE NO: 01

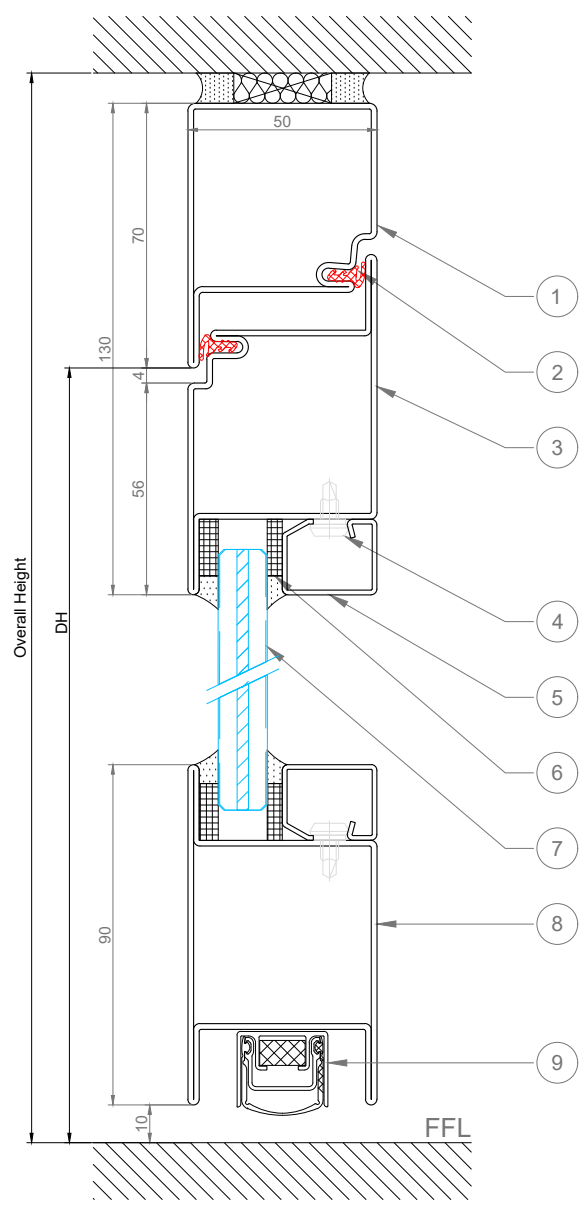
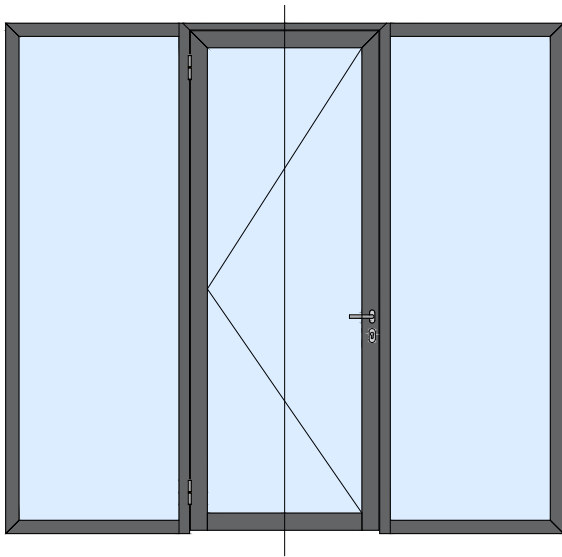

Door Height Parameters		
	Latched doors	Unlatched doors
Max Door Height	3393mm	2540mm
Max Overall Height	3478mm	2625mm

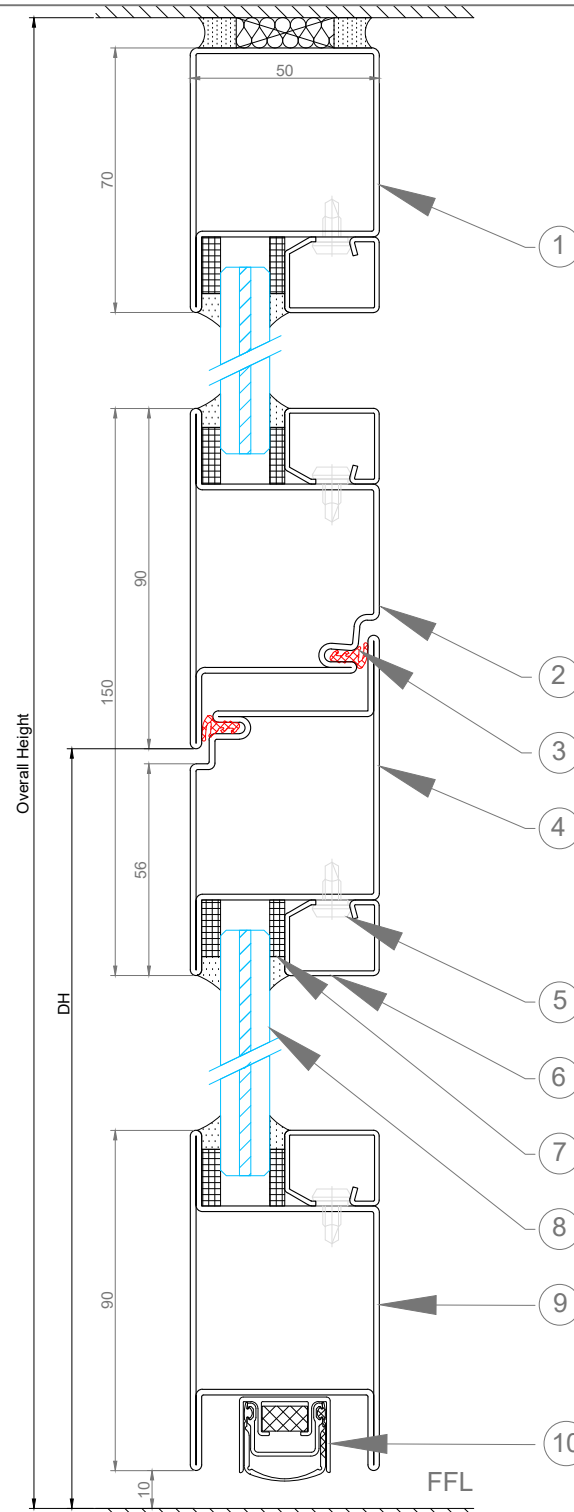
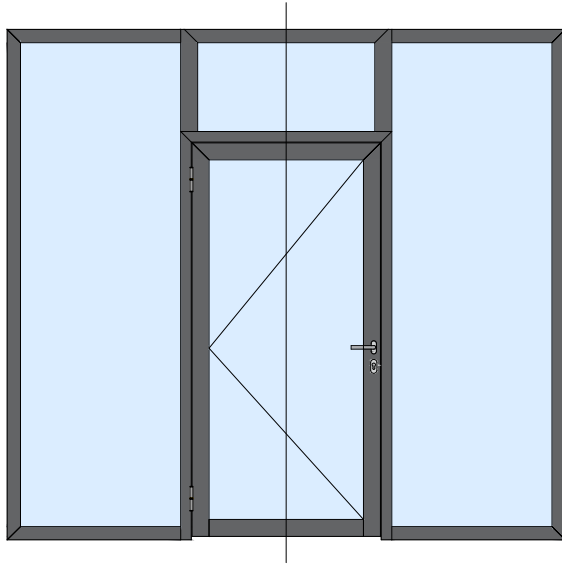

Door Height Parameters		
	Latched	Unlatched
Overpanel Height	970mm	613mm
Door Height	3393mm	2540mm
Overall Height	4015mm	3000mm

DEFENCE E60



COMPONENT KEY:

1	50 x 70mm Frame L
2	50 x 90mm Door T
3	Door rebate gasket
4	50 x 90mm Door Z
5	Glazing bead stud
6	25 x 20mm Glazing bead
7	Ceramic glazing tape
8	13mm E60 fire glass
9	50 x 90mm Door H
10	Automatic drop smoke seal

NOTES:

ALL DIMENSIONS ARE NOMINAL & IN mm

JUNCTION CATEGORY:

-  Single Glazed
-  Vertical Door with overpanel
-  60 min Integrity
0 min Insulation

DRAWING NO:
KDE60-VD-02

DATE:
20/07/21

SCALE:
1:2

ISSUE NO:
01

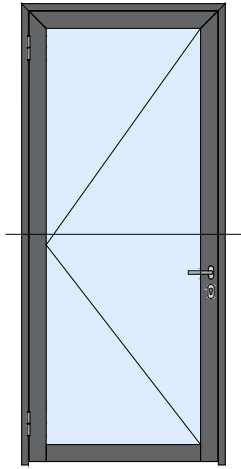

Door Width Parameters		
	Min	Max
DW	500mm	1610mm
ECO = DW - 120mm		



www.komfort.com

DEFENCE E60

COMPONENT KEY:

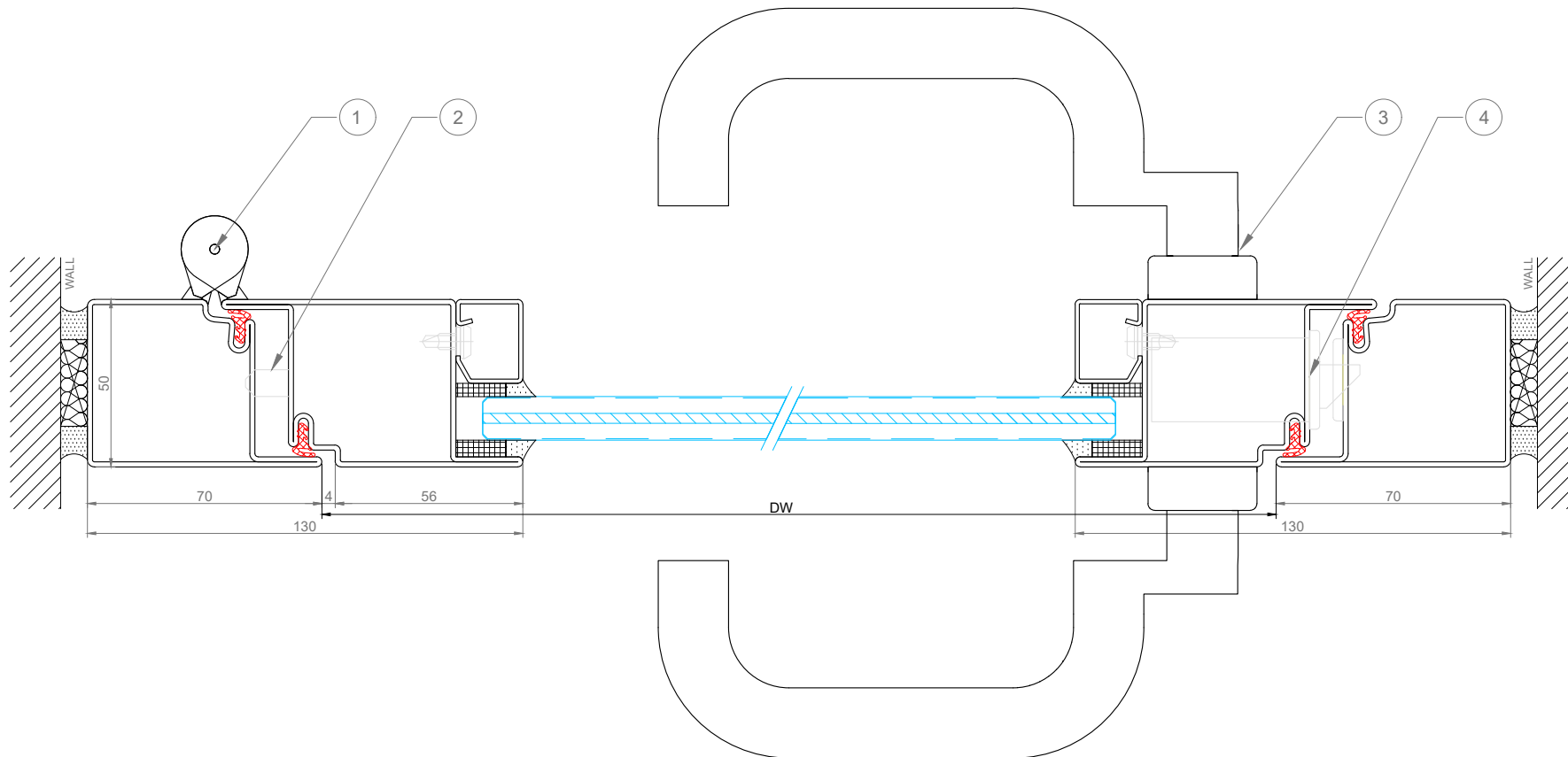

1	Weld-on barrel hinge
2	Hinge locking pin
3	SSS lever handle
4	Latch



NOTES:

ALL DIMENSIONS ARE NOMINAL & IN mm

JUNCTION CATEGORY:

-  Single Glazed
-  Horizontal Single Door Latched & rebated
-  60 min Integrity
0 min Insulation

DRAWING NO:
KDE60-HD-01

DATE:
20/07/21

SCALE:
1:2

ISSUE NO:
01

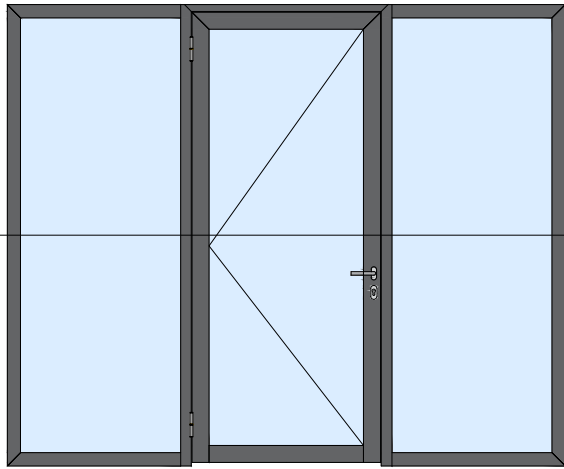

Door Width Parameters		
	Min	Max
DW	500mm	1610mm
ECO = DW - 120mm		



www.komfort.com

DEFENCE E60

COMPONENT KEY:

1	Weld-on barrel hinge
2	Hinge locking pin
3	SSS lever handle
4	Latch

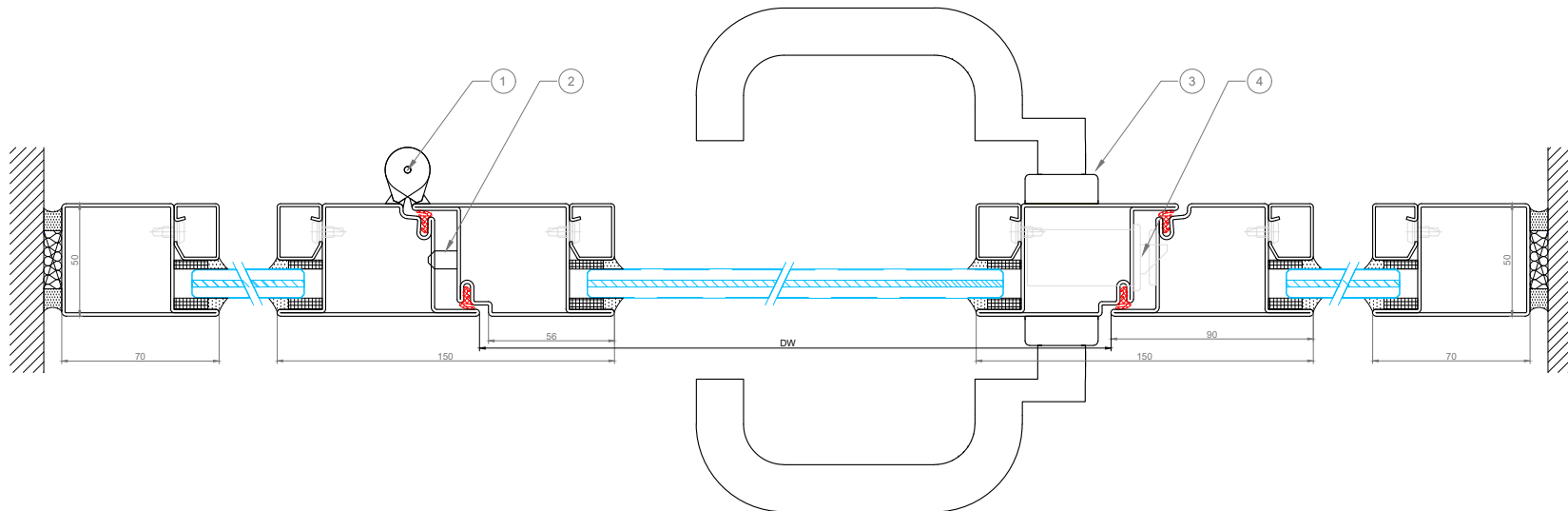

NOTES:

ALL DIMENSIONS ARE NOMINAL & IN mm

JUNCTION CATEGORY:

-  Single Glazed
-  Horizontal Single Door Latched & rebated
-  60 min Integrity
0 min Insulation

DRAWING NO: KDE60-HD-02 DATE: 20/07/21

SCALE: 1:2 ISSUE NO: 01

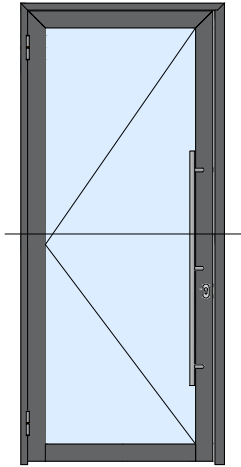

Door Width Parameters		
	Min	Max
DW	532mm	1200mm
ECO = DW - 110mm		



www.komfort.com

DEFENCE E60

COMPONENT KEY:

1	Weld-on barrel hinge
2	Hinge locking pin
3	SSS pull handle
4	Non-rebated meeting style gasket

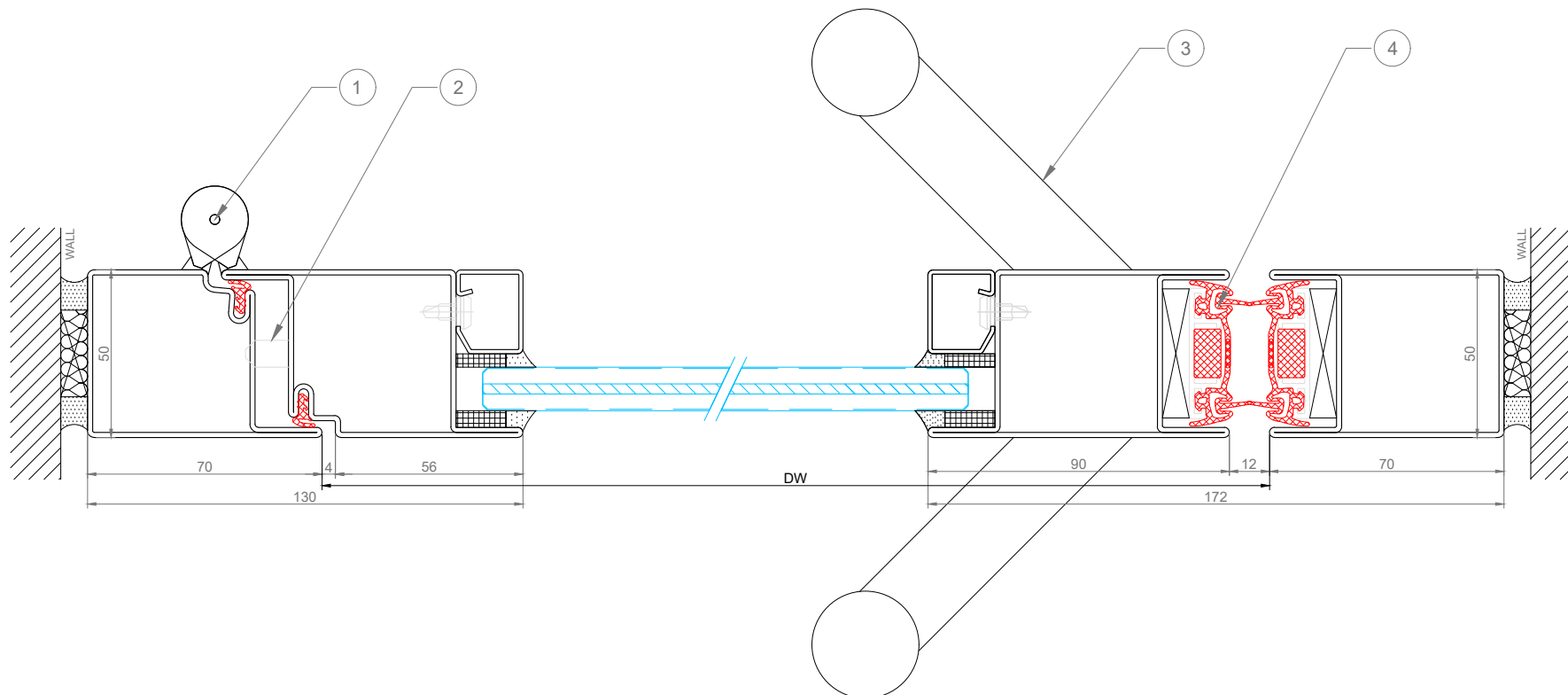

NOTES:

ALL DIMENSIONS ARE NOMINAL & IN mm

JUNCTION CATEGORY:

-  Single Glazed
-  Horizontal Single Door Unlatched
-  60 min Integrity
0 min Insulation

DRAWING NO: KDE60-HD-03 DATE: 20/07/21

SCALE: 1:2 ISSUE NO: 01

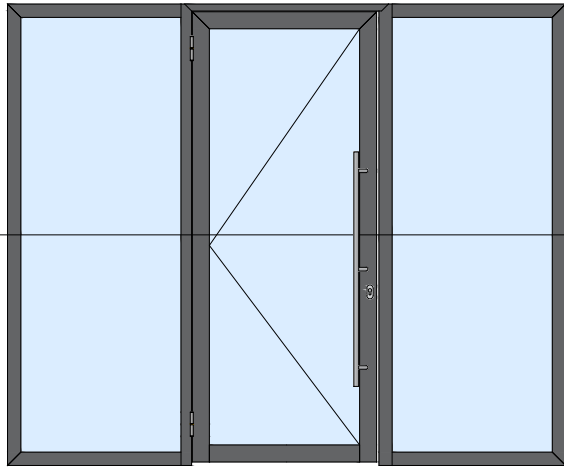

Door Width Parameters		
	Min	Max
DW	532mm	1200mm
ECO = DW - 110mm		



www.komfort.com

DEFENCE E60

COMPONENT KEY:

1	Weld-on barrel hinge
2	Hinge locking pin
3	SSS pull handle
4	Non-rebated meeting style gasket

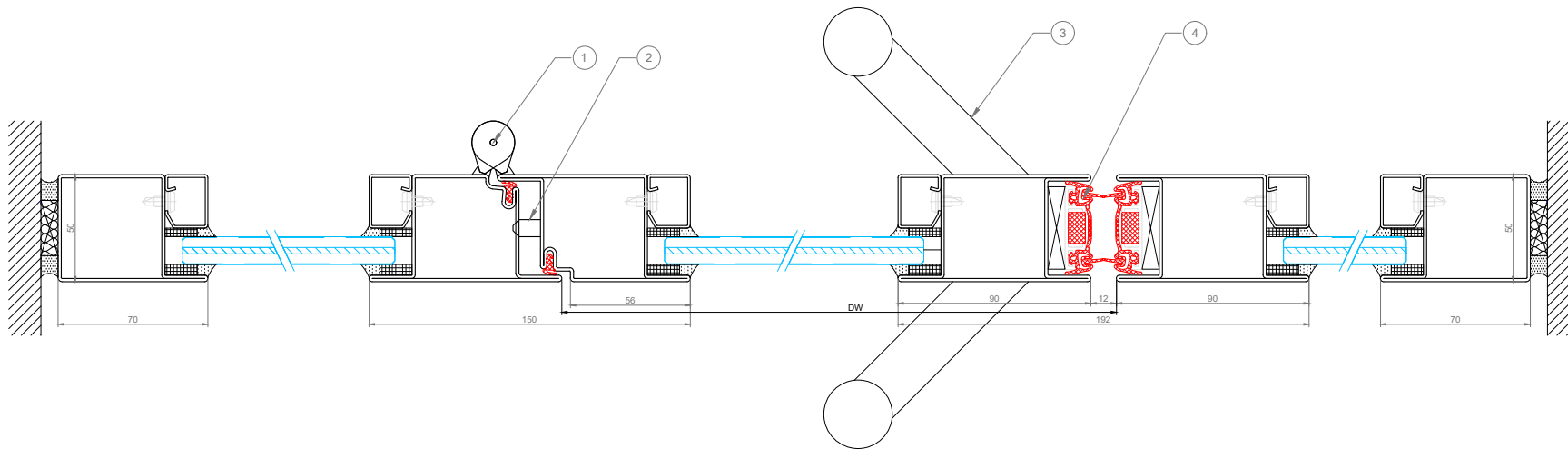

NOTES:

ALL DIMENSIONS ARE NOMINAL & IN mm

JUNCTION CATEGORY:

-  Single Glazed
-  Horizontal Single Door Unlatched
-  60 min Integrity
0 min Insulation

DRAWING NO: KDE60-HD-04 DATE: 20/07/21

SCALE: 1:2 ISSUE NO: 01

Suitable Supporting Structures (Jambs + Head)

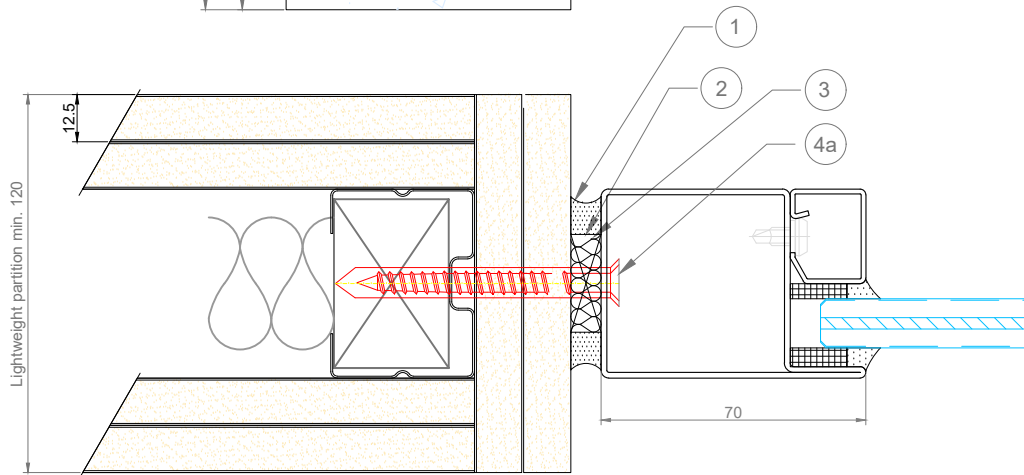
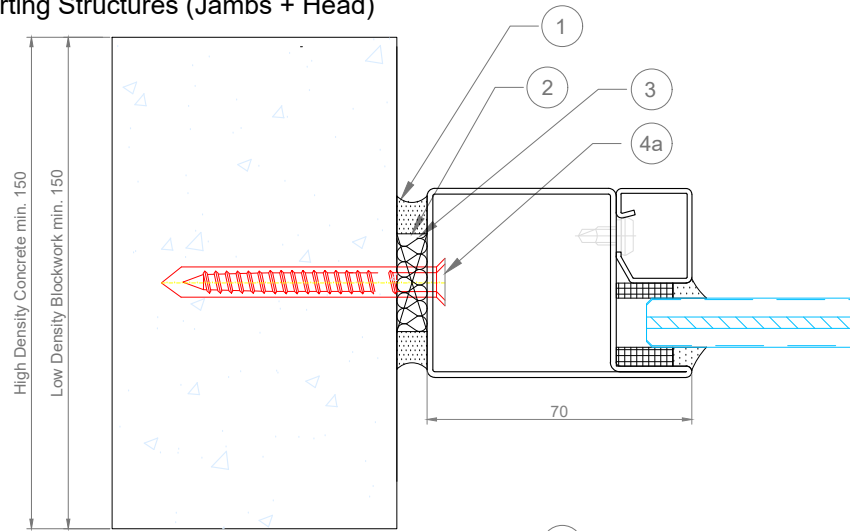

Fixing Locations

x	150mm
y	600mm

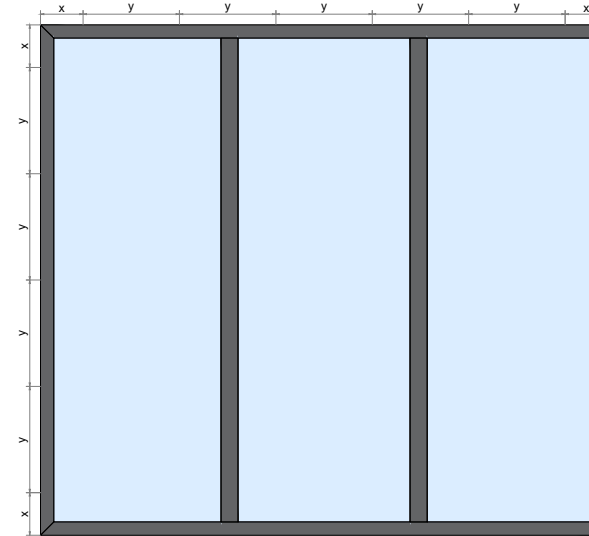

Supporting Construction Parameters			
Construction Type	Min thickness	Maximum Height	Butt jointed glazing *
Rigid - High Density	200mm	3350mm	N
Rigid - Low Density	200mm	2950mm	N
Lightweight partition (EN 1364-1) (Doors Only)	120mm	3000mm	N



www.komfort.com

DEFENCE E60

COMPONENT KEY:

1	Everbuild 400 FR Sealant
2	Mineral Wool min.80kg/m3
3	Steel packer
4a	8mm Universal (Concrete) Screw
4b	5.5mm Tek Screw

NOTES:



The base construction in all instances must be a rigid supporting structure - typically the structural floor of the building.

Where the element contains a door, the overall height will be limited to the maximum leaf height plus the permitted overpanel height.

ALL DIMENSIONS ARE NOMINAL & IN mm

* Subject to the maximum height of butt-jointed glass product

JUNCTION CATEGORY:

-  Single Glazed
-  Fixing & Supporting Constructions
-  60 min Integrity
0 min Insulation

DRAWING NO: KDE60-ZZ-01 DATE: 02/09/25

SCALE: 1:2 ISSUE NO: 01